

# Hennepin Ave S Reconstruction Project

(W Lake St. to 26th St)

Construction & Traffic Impact Update

April 27 - May 3, 2025

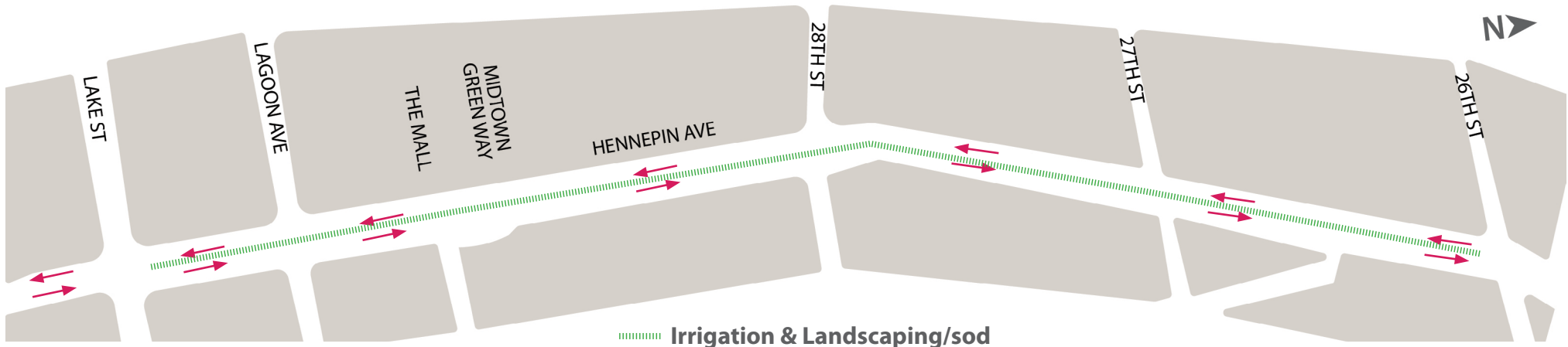

Page 1

**Construction work:** Partial Intersection Restriction Sanitary Sewer Conduit Work Storm Sewer

**Traffic impact:** Lane Closures/Work Zone Travel Lanes Roadway Closure Roadway & Sidewalk work



## WHAT'S HAPPENING

### Lake St to 26th St

- Hennepin Ave is open to traffic.
- Buses have returned to Hennepin
- There will be misc. work in the area during the spring months
- Planter rail installation will continue on Phase 1 around all planter boxes.
- Irrigation start up will begin followed by remaining landscaping and plantings/sod



## WHAT TO EXPECT

### Lake St to 26th St

- Roadway and utility punchlist work and final landscaping will occur in the spring months. This will require periodic short term closures of the bus/parking lane during the day.
- Cross streets will at times be reduced to 1-lane.
- Parking lanes will be closed at certain locations on side streets.
- Business access will remain open during the construction.
- Pedestrian detours will be set up as needed. Greater impacts can be expected at intersections where work is occurring.



## STAY CONNECTED

### Visit the project website

Sign up for project updates on the project website.

[Minneapolismn.gov/government/projects/hennepin-ave-s/](https://minneapolismn.gov/government/projects/hennepin-ave-s/)



## CONTACT US

Adam Hayow, Project Engineer - Public Works

📞 612-673-2172 📧 adam.hayow@minneapolismn.gov

# Hennepin Ave S Reconstruction Project

( W 26th St. to Douglas Ave)

## Construction & Traffic Impact Update

April 27 - May 3, 2025

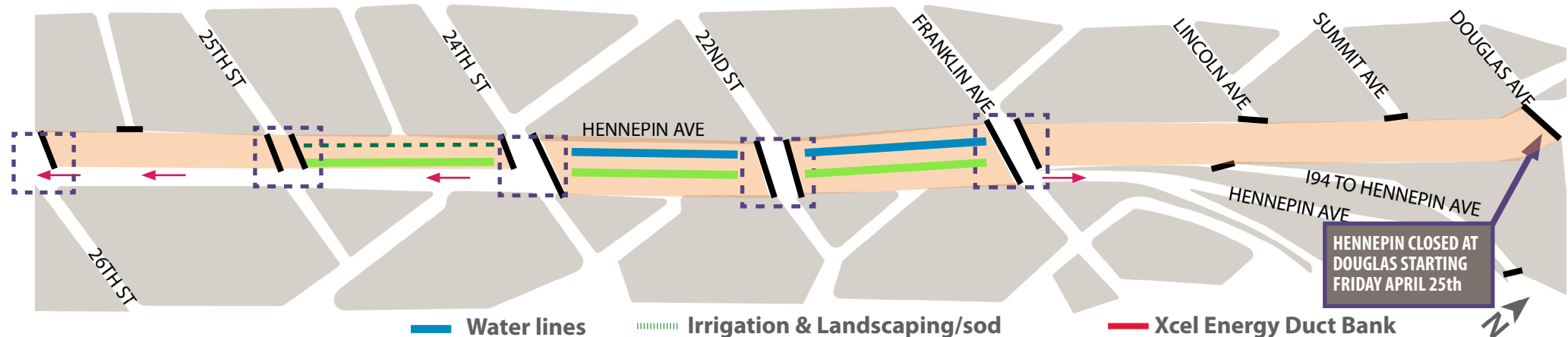

Page 2

### Construction work:



Partial Intersection Restriction

Sanitary Sewer



Conduit Work



Storm Sewer

### Traffic impact:



Lane Closures/Work Zone



Travel Lanes



Roadway Closure



Roadway & Sidewalk work



## WHAT'S HAPPENING

### 26th St to Douglas Ave

- Roadway construction has begun. This work includes removals, sawcutting, grading, storm sewer work and water service replacement- Hennepin is closed from 24th to 26th and cross streets are reduced to one lane.
- Temp lighting is being installed as existing lighting and signals are being removed.
- Hennepin will close from Franklin to Douglas starting Friday April 25th



## WHAT TO EXPECT

### 26th St to Douglas Ave

- Roadway & Utility work using heavy equipment will increase noise, vibration, and dust in work areas and sidewalks.
- Cross streets will at times be reduced to 1-lane or closed to traffic.
- Parking lanes will be closed at certain locations on side locations.
- Business access will remain open during the construction.
- Pedestrian detours will be set up as needed. Greater impacts can be expected at intersections where work is occurring.
- Traffic Delays in the area, closures, and detours.



## STAY CONNECTED

### Visit the project website

Sign up for project updates on the project website.

[Minneapolismn.gov/government/projects/hennepin-ave-s/](https://minneapolismn.gov/government/projects/hennepin-ave-s/)



## CONTACT US

Adam Hayow, Project Engineer - Public Works

612-673-2172 | [adam.hayow@minneapolismn.gov](mailto:adam.hayow@minneapolismn.gov)

# Hennepin Ave S Reconstruction Project

(W Lake St. to Douglas Ave.)

## Block-by-Block Work Summary

April 27 - May 3, 2025



STREET BLOCK	PROJECT RELATED WORK	ANTICIPATED ROAD/PEDESTRIAN RESTRICTIONS				
		TEMPORARY PED RAMPS	PARKING RESTRICTIONS	TWO LANES OPEN (5-9 AM + 3-7 PM)	ONE LANE OPEN	NOTES
Lake St. Intersection						
Lake St. - Lagoon Ave	Irrigation start up					
Lagoon Ave Intersection						
Lagoon Ave -29th St.	Irrigation start up					
29th St. Intersection						
29th St. - 28th St.	Irrigation start up					
28th St. Intersection						
28th St. - 27th St.	Irrigation start up					
27th St. Intersection						
27th St - 26th St.	Irrigation start up					
26th St. Intersection						
26th St. -25th St.		X	X		X	Single Business access lane south bound
25th St. Intersection		X	X			
25th St - 24th St.	Water Service & Hydrant replacements, Sanitary Reconstructs, Storm Sewer	X	X		X	Single Business access lane south bound
24th St. Intersection		X	X			
24th St. - 22nd St.	Water Service & Hydrant replacements, Sanitary Reconstructs		X		X	Closed
22nd St. Intersection		X	X			
22nd St. - Franklin Ave.	Water Service & Hydrant replacements, Sanitary Reconstructs		X			Closed
Franklin Ave. Intersection	Removals & Temp lighting		X			
Franklin Ave -Lincoln Ave.	Removals & Temp lighting		X			Closed
Lincoln Ave. Intersection	Removals & Temp lighting	X	X			Closed
Lincoln Ave. - Summit Ave.	Removals & Temp lighting		X			Closed

# Hennepin Ave S Reconstruction Project

(W Lake St. to Douglas Ave.)

Detour Routes  
April 27 - May 3, 2025



PHASE 2



Local / Business  
Access Only  
1 Lane Southbound

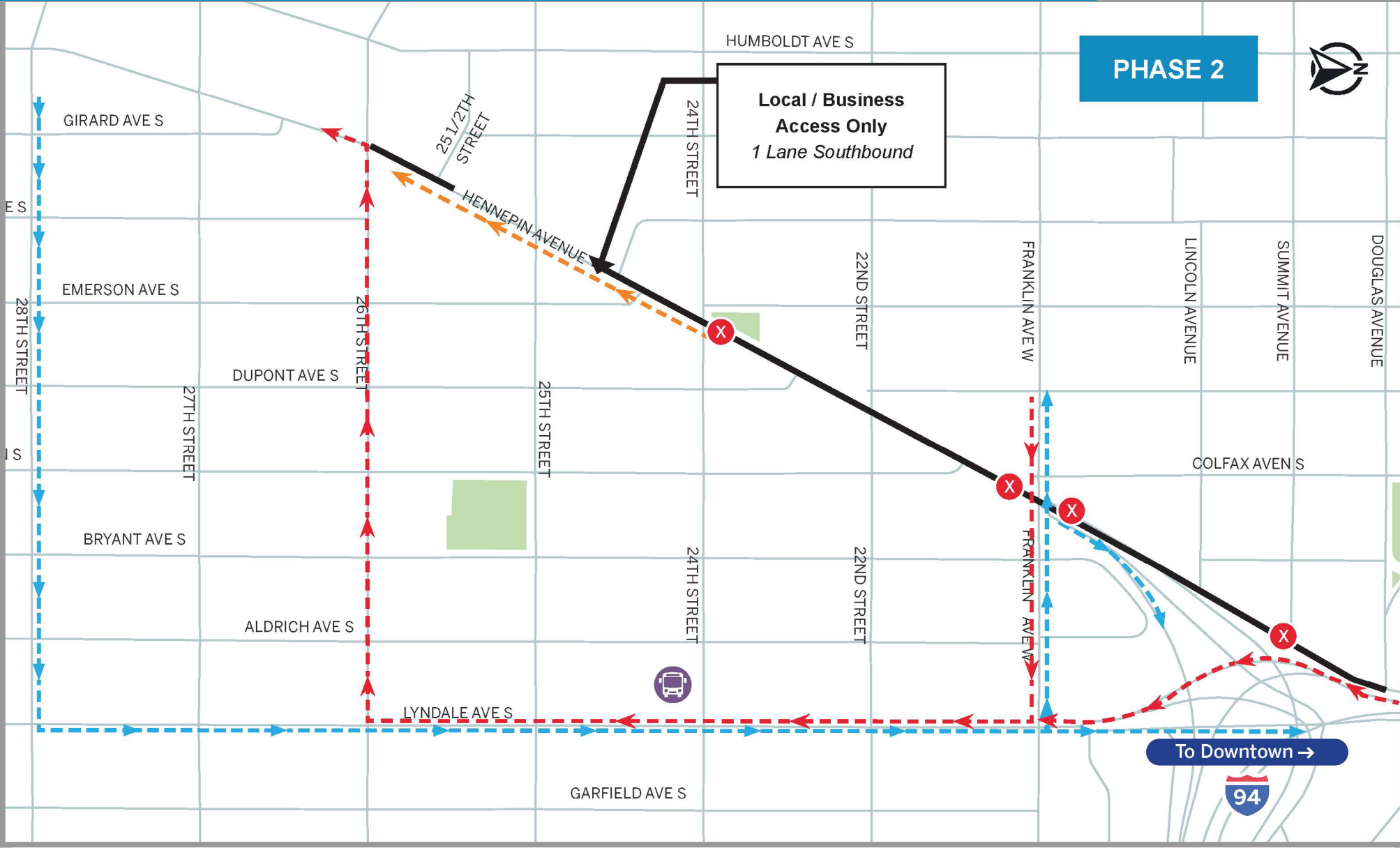

- Detour Route N
- Detour Route S
- Phase 2 Construction zone
- Business Access Route
- Road Closed
- Bus Detour

# Hennepin Ave S Reconstruction Project

(W Lake St. to Douglas Ave.)

Business Parking / Access

April 27 - May 3, 2025

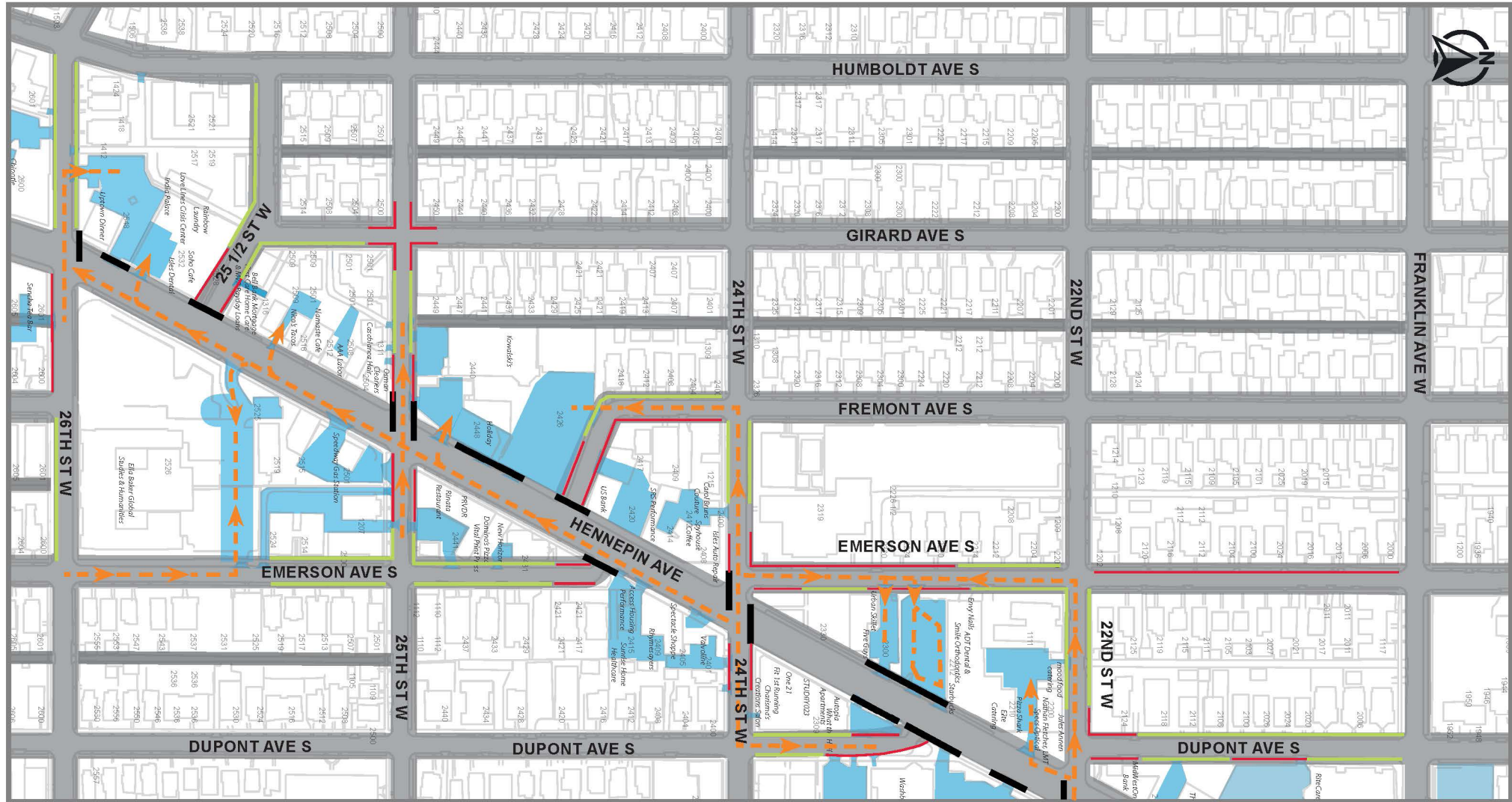

- Private/Business parking
- No Parking
- Onstreet Parking
- Road or Access Closed
- Business Access Route



# Hennepin Ave S Reconstruction Project

(W Lake St. to Douglas Ave.)

Business Parking / Access

April 27 - May 3, 2025

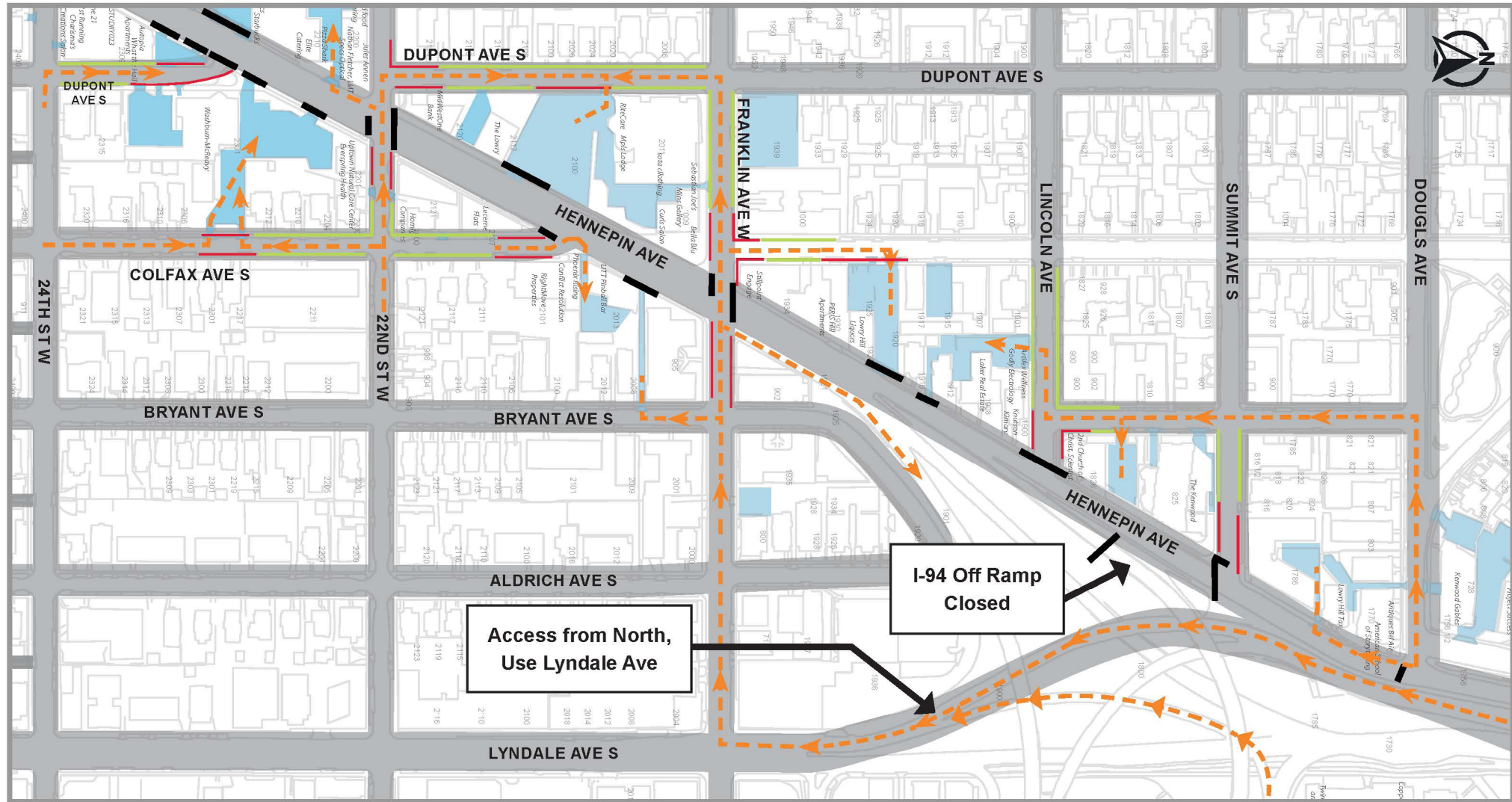

- Private/Business parking
- No Parking
- Onstreet Parking
- Road or Access Closed
- Business Access Route