

Hennepin Ave S Reconstruction Project

(W Lake St. to 26th St)

Construction & Traffic Impact Update

April 20 - 26, 2025

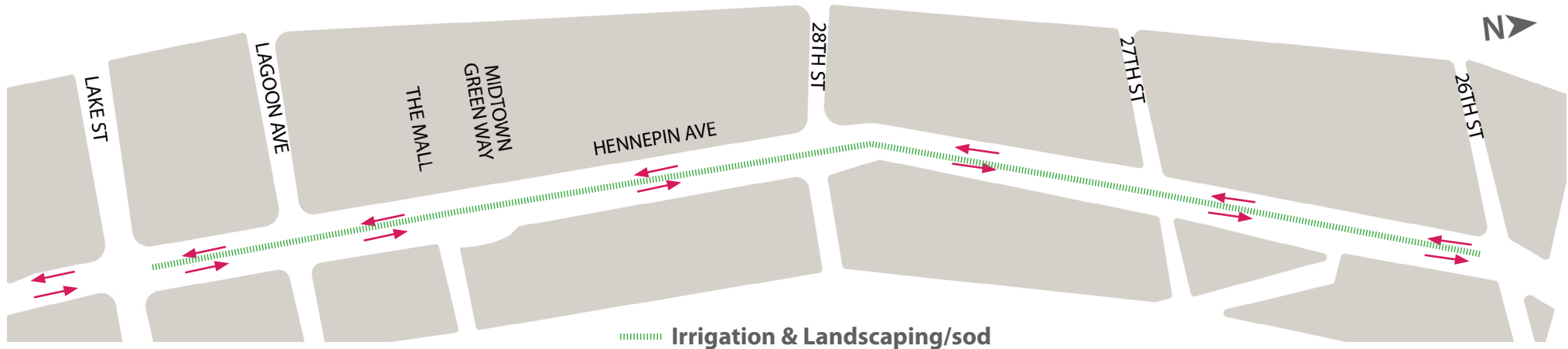

Construction work: Partial Intersection Restriction Sanitary Sewer Conduit Work Storm Sewer

Traffic impact: Lane Closures/Work Zone Travel Lanes Roadway Closure Roadway & Sidewalk work

Page 1



WHAT'S HAPPENING

Lake St to 26th St

- Hennepin Ave is open to traffic.
- Buses have returned to Hennepin
- There will be misc. work in the area during the spring months
- Planter rail installation will continue on Phase 1 around all planter boxes.
- Irrigation start up will begin followed by remaining landscaping and plantings/sod



WHAT TO EXPECT

Lake St to 26th St

- Roadway and utility punchlist work and final landscaping will occur in the spring months. This will require periodic short term closures of the bus/parking lane during the day.
- Cross streets will at times be reduced to 1-lane.
- Parking lanes will be closed at certain locations on side streets.
- Business access will remain open during the construction.
- Pedestrian detours will be set up as needed. Greater impacts can be expected at intersections where work is occurring.



STAY CONNECTED

Visit the project website

Sign up for project updates on the project website.

[Minneapolismn.gov/government/projects/hennepin-ave-s/](https://minneapolismn.gov/government/projects/hennepin-ave-s/)



CONTACT US

Adam Hayow, Project Engineer - Public Works

📞 612-673-2172 📧 adam.hayow@minneapolismn.gov

Hennepin Ave S Reconstruction Project

(W 26th St. to Douglas Ave)

Construction & Traffic Impact Update

April 20 - 26, 2025

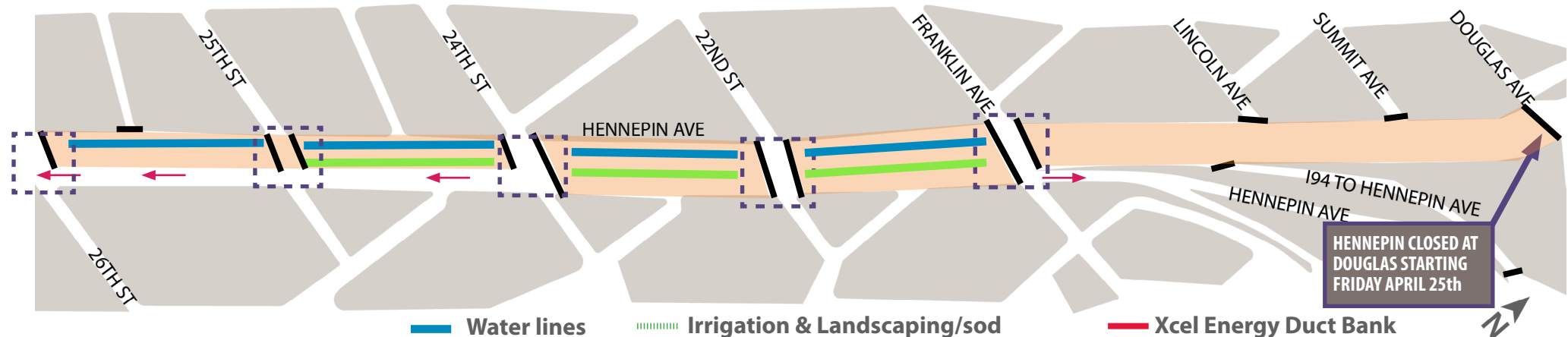

Construction work:



Partial Intersection Restriction

Sanitary Sewer



Conduit Work



Storm Sewer

Traffic impact:



Lane Closures/Work Zone



Travel Lanes



Roadway Closure



Roadway & Sidewalk work

Page 2



WHAT'S HAPPENING

26th St to Douglas Ave

- Roadway construction has begun. This work includes removals, sawcutting, grading, storm sewer work and water service replacement- Hennepin is closed from 24th to 26th and cross streets are reduced to one lane.
- Temp lighting is being installed as existing lighting and signals are being removed.
- Hennepin will close from Franklin to Douglas starting Friday April 25th



WHAT TO EXPECT

26th St to Douglas Ave

- Roadway & Utility work using heavy equipment will increase noise, vibration, and dust in work areas and sidewalks.
- Cross streets will at times be reduced to 1-lane or closed to traffic.
- Parking lanes will be closed at certain locations on side locations.
- Business access will remain open during the construction.
- Pedestrian detours will be set up as needed. Greater impacts can be expected at intersections where work is occurring.
- Traffic Delays in the area, closures, and detours.



STAY CONNECTED

Visit the project website

Sign up for project updates on the project website.

[Minneapolismn.gov/government/projects/hennepin-ave-s/](https://minneapolismn.gov/government/projects/hennepin-ave-s/)



CONTACT US

Adam Hayow, Project Engineer - Public Works

612-673-2172 | adam.hayow@minneapolismn.gov

Hennepin Ave S Reconstruction Project

(W Lake St. to Douglas Ave.)

Block-by-Block Work Summary

April 20 - 26, 2025



STREET BLOCK	PROJECT RELATED WORK	ANTICIPATED ROAD/PEDESTRIAN RESTRICTIONS				
		TEMPORARY PED RAMPS	PARKING RESTRICTIONS	TWO LANES OPEN (5-9 AM + 3-7 PM)	ONE LANE OPEN	NOTES
Lake St. Intersection						
Lake St. - Lagoon Ave	Planter Railings, Irrigation start up					
Lagoon Ave Intersection						
Lagoon Ave -29th St.	Planter Railings, Irrigation start up					
29th St. Intersection						
29th St. - 28th St.	Planter Railings, Irrigation start up					
28th St. Intersection						
28th St. - 27th St.	Planter Railings, Irrigation start up					
27th St. Intersection						
27th St - 26th St.	Planter Railings, Irrigation start up					
26th St. Intersection						
26th St. -25th St.	Water Service & Hydrant replacements, Sanitary Reconstructs	X	X		X	Single Business access lane south bound
25th St. Intersection	Removals & Temp lighting	X	X			
25th St - 24th St.	Water Service & Hydrant replacements, Sanitary Reconstructs	X	X		X	Single Business access lane south bound
24th St. Intersection	Removals & Temp lighting	X	X			
24th St. - 22nd St.	Removals & Temp lighting		X		X	Closed
22nd St. Intersection	Removals & Temp lighting	X	X			
22nd St. - Franklin Ave.	Removals & Temp lighting		X			Closed
Franklin Ave. Intersection	Removals & Temp lighting		X			
Franklin Ave -Lincoln Ave.	Removals & Temp lighting		X			Closed
Lincoln Ave. Intersection	Removals & Temp lighting	X	X			Closed
Lincoln Ave. - Summit Ave.	Removals & Temp lighting		X			Closed
Summit Ave. Intersection	Removals & Temp lighting	X	X			Closed

Hennepin Ave S Reconstruction Project

(W Lake St. to Douglas Ave.)

Detour Routes
April 20 - 26, 2025



PHASE 2



Local / Business
Access Only
1 Lane Southbound

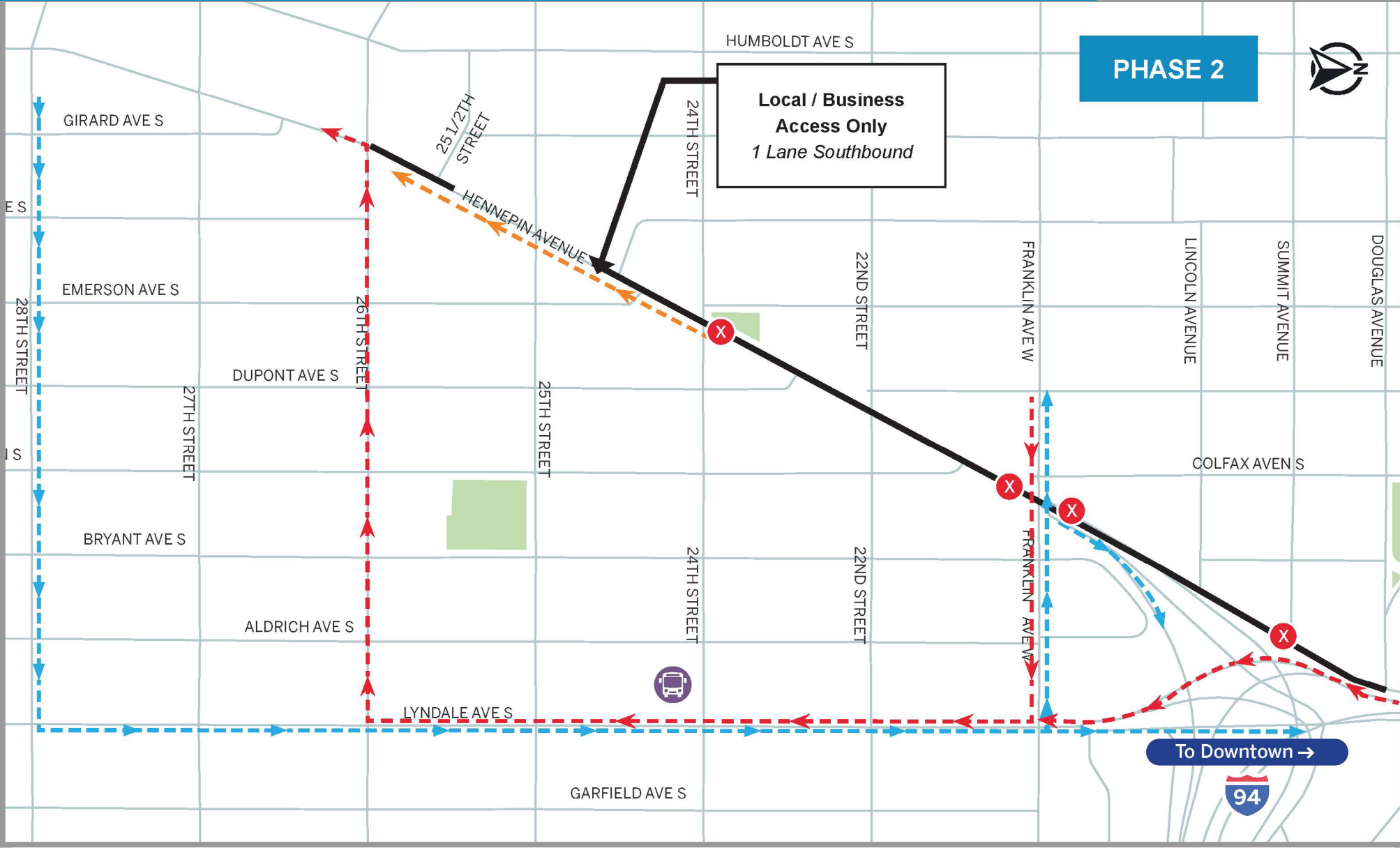

- Detour Route N
- Detour Route S
- Phase 2 Construction zone
- Business Access Route
- Road Closed
- Bus Detour

(W Lake St. to Douglas Ave.)

April 20 - 26, 2025



Hennepin Ave S Reconstruction Project

(W Lake St. to Douglas Ave.)

Business Parking / Access

April 20 - 26, 2025

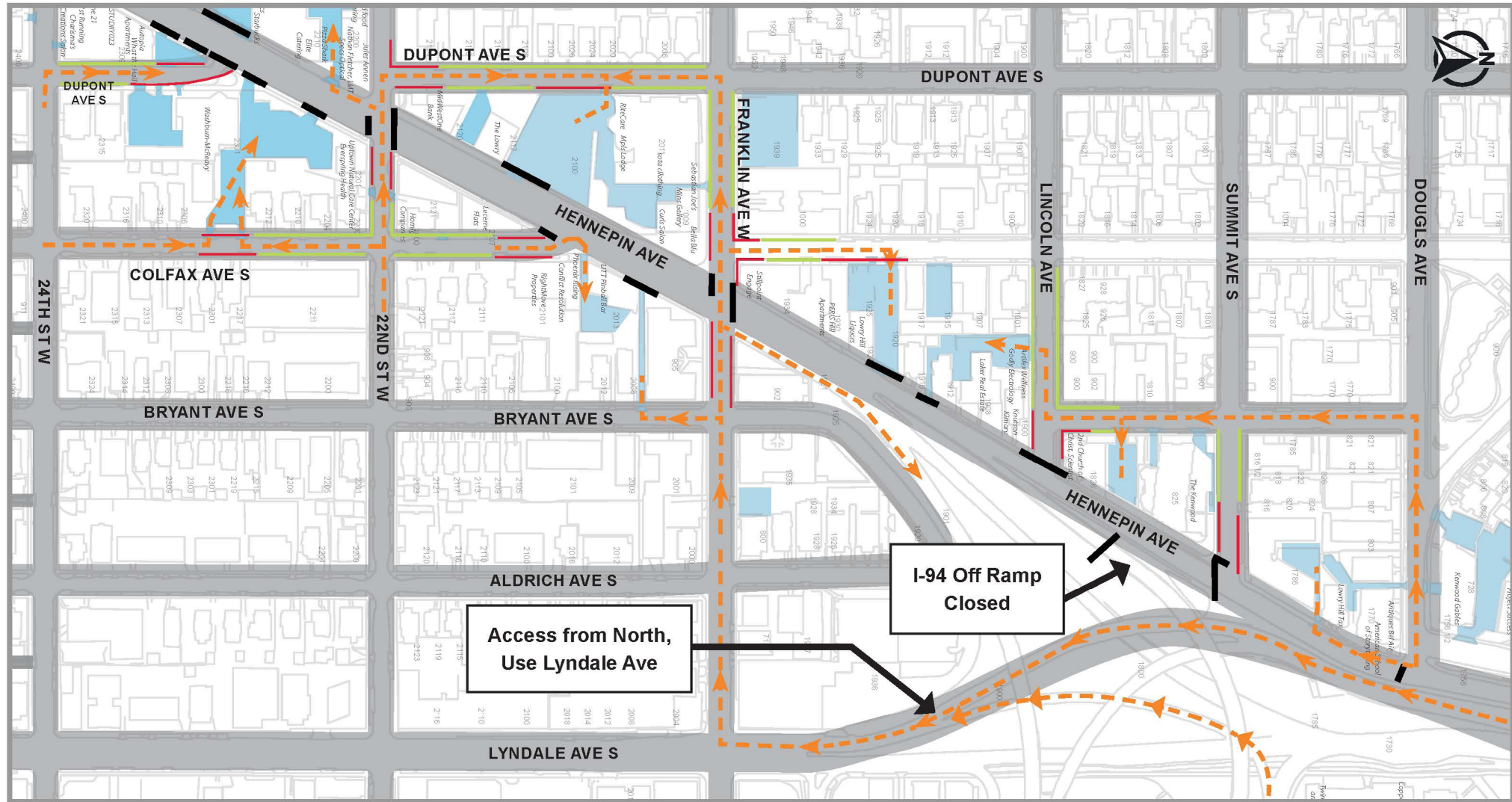

- Private/Business parking
- No Parking
- Onstreet Parking
- Road or Access Closed
- Business Access Route