

# PRIMARY ZONING DISTRICTS

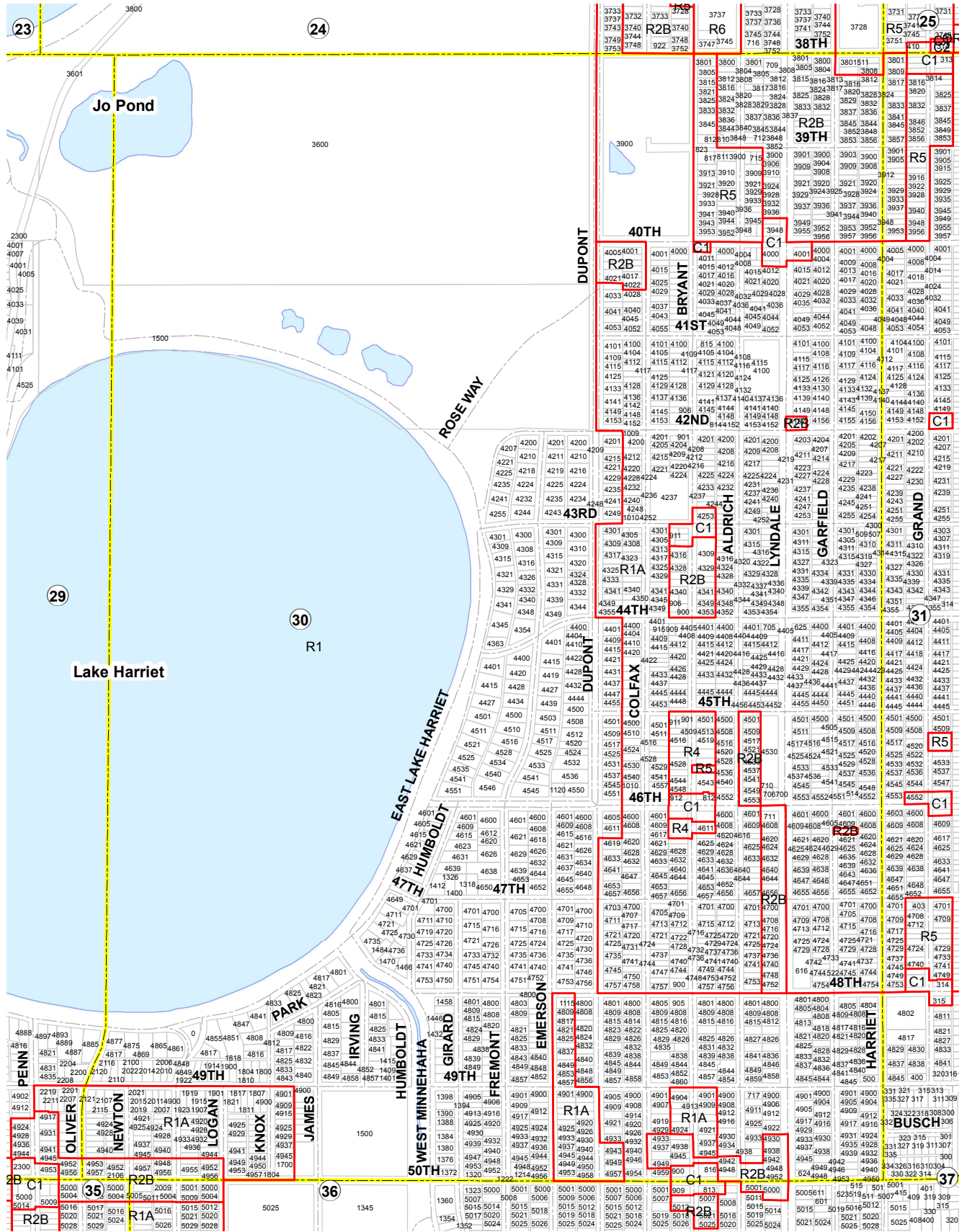

- |   |  |  |
|---|--|--|
| <b>RESIDENCE DISTRICTS</b><br>LOW DENSITY<br>R1<br>R2<br>R3<br>R4<br>R5<br>R6 | <b>OFFICE RESIDENCE DISTRICTS</b><br>OR1<br>OR2<br>OR3 | <b>DOWNTOWN DISTRICTS</b><br>B4<br>B4C<br>B4CS |
| <b>MEDIUM DENSITY DISTRICTS</b><br>R1<br>R2<br>R3<br>R4<br>R5<br>R6           | <b>COMMERCIAL DISTRICTS</b><br>C1<br>C2<br>C3<br>C4    | <b>INDUSTRIAL DISTRICTS</b><br>I1<br>I2<br>I3  |

12 PLATE NUMBER

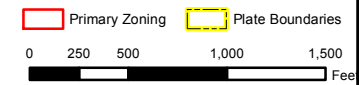

Last Amended: February 21, 2014

MINNEAPOLIS ZONING PLATE 30